

TOWA

The Official Publication of the **Texas Outdoor Writers Association**

UPDATE ON 2011 TOWA ANNUAL CONFERENCE

Port Royal Resort and Conference Center Happy to Host TOWA

By Jonette Childs, Site Selection Committee Chairwoman

RESORT OVERVIEW

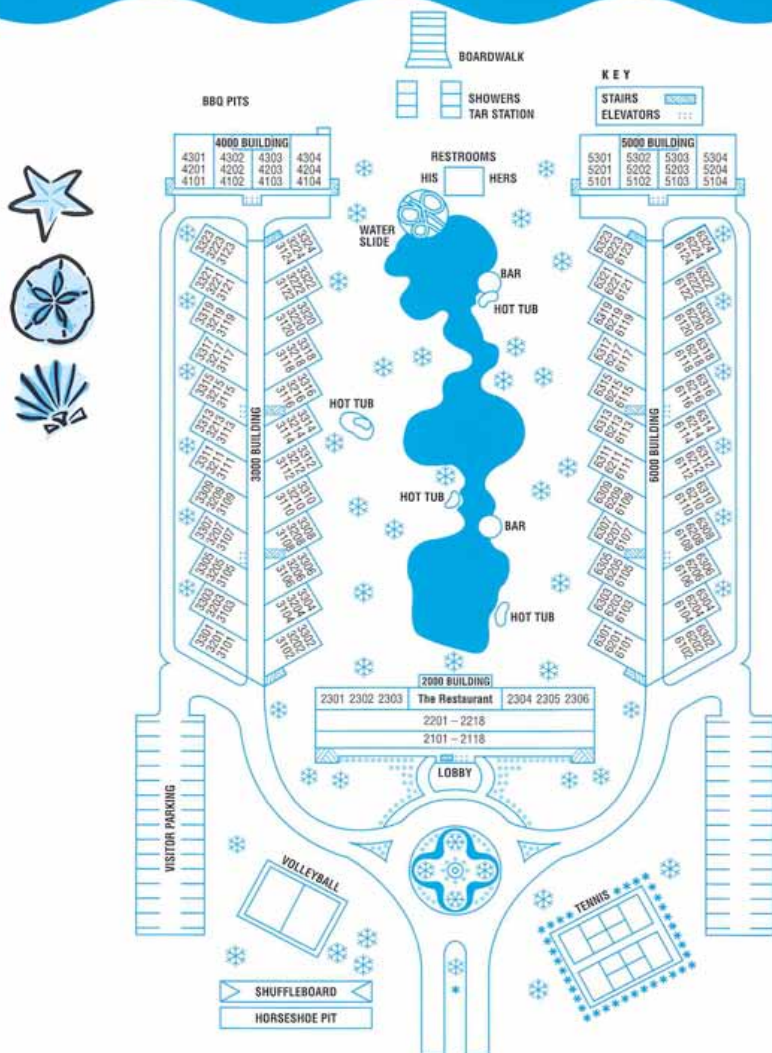

I made a visit on Sept. 15 to Port Royal Resort and Conference Center in Port Aransas to meet the new sales manager, Stacy Trevino, who will be our “keeper” for TOWA’s 53rd annual conference.

Most of the staff, who were so helpful on our last visit, is still with the hotel including Chef James, who did such a great job feeding us in 2009. We can be confident that the facility is very excited about hosting us again.

The hotel is still in first-class shape and offers excellent meeting rooms.

Continued on Page 2

CALENDAR

Oct. 22 – Operation Game Thief Alamo Area Sporting Clays Shooting Event from 11 a.m. to 6 p.m. at the San Antonio Gun Club in Olmos Park. For more information, call (512) 389-4381 or visit www.ogttx.com.

Feb. 24-26, 2011 – The 53rd annual TOWA conference will be held at Port Aransas with the Port Royal Ocean Resort & Conference Center serving as the host hotel. Hotel information is available at <http://port-royal.com>.

TOWA OFFICERS, BOARD

PRESIDENT

Bob Lusk (903) 564-5372
pondboss@texoma.net

PRESIDENT-ELECT

David Sikes (361) 886-3616
sikesd@caller.com

TREASURER

Bill E. Mills (281) 448-5811
offtheroad.mills@earthlink.net

EXECUTIVE DIRECTOR

Larry J. LeBlanc (936) 856-6788
904 W. Montgomery, Ste. 4
Willis, TX 77378
towa@suddenlink.net cell (936) 524-0761
fax (936) 856-6788

BOARD MEMBERS

BOARD CHAIRMAN

John Goodspeed (210) 250-3417
john@johngoodspeed.com

T.J. Greaney (2013) (512) 789-3838
tj@countrylinemagazine.com

Mike Price (2011) (281) 431-0085
bymikeprice@comcast.net

Kendal Hemphill (2013) (325) 347-6440
jeep@verizon.net

Peggy York (2012) (210) 647-7053
peggy.york@sbcglobal.net

Steve LaMascus (2012) (830) 563-2656
slamascus@sbcglobal.net

Susan Ebert (2013) (512) 431-2013
sebert@suddenlink.net

COMMITTEE CHAIRS

CONFERENCE CHAIRMAN

David Sikes (361) 886-3616
sikesd@caller.com

CONFERENCE PROGRAM CO-CHAIRS

T.J. Greaney (512) 789-3838
tj@countrylinemagazine.com

David Sikes (361) 886-3616
sikesd@caller.com

SCHOLARSHIP

Judy Mills, Marrienne Odom (281) 448-5811
offtheroad.mills@earthlink.net

MEMBERSHIP

David Sikes (361) 886-3616
sikesd@caller.com

SITE SELECTION

Jonette Childs (361) 729-0239
saltex@pyramid3.net

AUCTIONS

T.J. Greaney (512) 789-3838
tj@countrylinemagazine.com

EIC AWARDS

Kendal Hemphill (325) 347-6440
jeep@verizon.net

TOWA PHOTOGRAPHERS

Gerald Burleigh and David Redwine

TOWA HISTORIAN

John Thompson

TOWA News is published monthly for the Texas Outdoor Writers Association by Ralph Winingham. Layout by SusanEbertink, sebert@suddenlink.net. Contributors are urged to submit material by the 15th of each month. For advertising information, contact Ralph Winingham at (210) 764-2450 or rwiningham@att.net. TOWA News is emailed to members and mailed first class from San Antonio.

TOWA was formed in 1958 as a professional/social organization for those who communicate about hunting, fishing and other outdoor pursuits, as well as those in business and industry connected with the outdoors.



The TOWA Newsletter is proudly sponsored by Gulf States Toyota. For information, go to www.buyatoyota.com.



2011 TOWA ANNUAL CONFERENCE

Continued from Page 1

The grounds are as beautiful as you remember them to be. And, best of all, the rates from our last visit will be honored again. That rate is \$100 for a two-bedroom condo with two baths and a majestic view.

More information on how and when to make your reservations will be available in the next newsletter. For now, mark your calendar for Feb. 24-26, 2011, and start looking forward to a great conference.

Following are details from the Port Royal website:

ONE BEDROOM CONDOMINIUM UNITS



The One Bedroom Condominium Units are perfect for the small family, business accommodation or honeymoon getaway. With a great view overlooking the Gulf of Mexico and the pool area, this unit will give you and your family the comfort and relaxation of everything the resort has to offer.

- ★ Sleeps 1-4 People
- ★ 660 sq. feet - Master Bedroom King Size Bed
- ★ All Suites overlook the Gulf of Mexico & Blue Lagoon Pool

TWO BEDROOM CONDOMINIUM UNITS

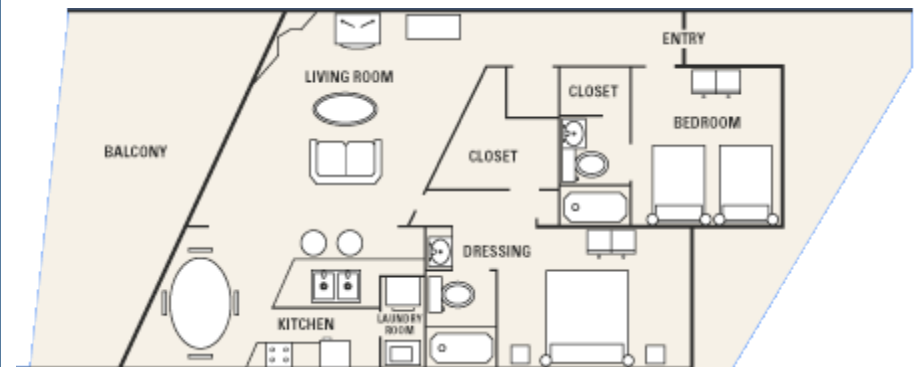

The Two Bedroom Condominium Units are great for medium sized families and business groups that need extra space to accommodate more people. These units feature either a pool or a partial view of the Gulf of Mexico. Units typically have a master bedroom with a king size bed with the second bedroom featuring either two twin sized beds, a queen sized bed or a king sized bed.

- ★ Sleeps 1-6 Persons
- ★ 1,300 sq. feet - Master Bedroom King Size Bed
- ★ Second Bedroom, 2 Twins or King or Queen Size Bed
- ★ Aero Beds and/or Roll-a-ways
- ★ Suites have a Pool or Partial Gulf View

TOWA Excellence in Craft Contest Deadline Just Around the Corner

By Kendal Hemphill, EIC Chairman

Entries are already starting to trickle in for the 2011 EIC competition, mainly from people who are habitually early for everything, even dentist appointments. I hate to criticize, but being ahead of schedule is not always such a good idea. After all, your funeral is coming up one of these days.

But sending in your EIC entries before the deadline, no pun intended, carries no penalty. Book entries are due November 1, and everything else must be postmarked on or before December 1. I can be bought, but not in the area of late EIC entries. My wife gets the mail.

There are a few changes in the categories this year, so please peruse the following list carefully. We have tried to streamline the program by eliminating some sections that habitually get very few entries, sometimes combining them with other small categories instead of cutting them out altogether.

Management apologizes from the bottom of its heart, liver, kidneys, and, of course, spleen, if a category you really wanted to enter is not there anymore. We sincerely want to make this work for everyone, so voice your complaints, and we can adjust the whole enchilada for next year according to popular demand. This is your competition, and we want to make it fun and challenging for everyone.

The judging of the contest to be conducted by members of the Florida Outdoor Writers Association in a reciprocal agreement with TOWA, with winners to receive their awards and be honored at the Feb. 26, 2011, awards banquet in Port Aransas.

In addition to the changes in the guidelines, additional cash prizes will be offered for winners, with \$200 going to first place; \$50 to second place; and \$25 to third place. The cash awards are courtesy of Supporting Member Craig Eppling of Chevrolet.

Bear in mind that this year, like last year, two entries are allowed in each category. We are still considering allowing the same article/photo/etc. to be entered in multiple categories when it qualifies for each, but have not yet made that step. Your opinion is solicited.

Feel free to call (325) 347-6440 or email jeep@verizon.net if you have any questions or recommendations about the contest and the new guidelines.

Entries are still only \$10 each. Enter early. Enter often. And as my dad used to tell my mom when she was headed for the beauty parlor – good luck to you.

EXCELLENCE IN CRAFT CONTEST RULES AND GUIDELINES

1. Entries must be postmarked by Dec. 1, 2010. Entries postmarked after that date will be returned unopened.
2. Each member is limited to no more than two entries per category. The same entry may be submitted in more than one category. The Over 25,000 circulation and Under 25,000 circulation division has been eliminated in all categories except for Outdoor Publications. See each category for details.
3. Entries must have been published, distributed or broadcast in Texas between Oct. 15, 2009, and Nov. 15, 2010.
4. Each entry must be accompanied by an official 2011 TOWA EIC entry form. Legible photocopies of the 2011 form are acceptable. Forms must be taped to the front side of the envelope.
5. EIC officials will take measures to ensure that all entries are available to be picked up at the conference, but will not be responsible for loss. Those entries not picked up at the conference will be destroyed.
6. Judges will be knowledgeable in the field they are asked to judge; as professionals, there will be no reason to delete bylines or names.
7. The EIC chairman will be the sole judge of any dispute or question concerning the competition.
8. Winners will be announced at the annual conference. All judges' decisions are final.
9. Each entry must be submitted in a separate manila envelope. Two copies (one original and one photocopy is acceptable) of each entry in the writing categories must be submitted with one completed copy of the entry form. Send tear sheets, not complete publications. Note about Internet work: If an article has not been published and paid for, or used as a paid-for

TOWA Excellence in Craft Contest Categories

image in an Internet publication, it does not qualify. If work appeared on an Internet site, a printout of the web page will suffice as a tear sheet.

Both copies of the printed material will be submitted in a clasp envelope, with the entry form taped to the front of the envelope. Clearly identify the category of each entry.

Photos, books, tapes, DVDs and CDs should also be placed in a clasp envelope with the entry form taped to the clasp less side of the envelope. Identify each entry so that it may be identified if it is separated from the form.

Only one copy of photography, radio and video entries is required. Photos should not be mounted. Photography entries must have a tear sheet attached showing the photo in print. Note about Internet work: If a photograph has not been published and paid for as a magazine image, or used as a paid-for image in an Internet publication, it does not qualify. The same qualification is true of illustrations. If work appeared on an Internet site, a printout of the web page will suffice as a tear sheet.

SEND A \$10 ENTRY FEE FOR EACH INDIVIDUAL SUBMISSION. Make all checks or money orders payable to TOWA. Do not send cash. You can include the fee for all entries on one check. If a check is not included with your entry package, the package will be returned to you marked, "Not valid for judging."

CASH AWARDS: A \$200 check will be awarded to first place winners in all categories; a \$50 check will be awarded to the second place winner; and a \$25 check will be awarded to the third place winner. Honorable mention recipients will continue to receive a certificate of their achievement.

PHOTOS: Attach clipping or tear sheet showing photo in print. The distinction between color and black & white photos has been eliminated. Photos should not be mounted and cannot be more than 11x14 inches in total size. Tape a second copy of the entry form to the back of the photo. Entries should be mailed in a manila clasp envelope with entry form taped to clasp less side.

CATEGORY 1) Outdoor Photography, People - Photos with an outdoor-related theme. Members are allowed to enter two photos in each category. Include tear sheet or web printout and one print. A print of each photo is required for judging. No slides will be accepted.

CATEGORY 2) Outdoor Photography, Wildlife/Nature - Photos with an outdoor-related theme. Members are allowed to enter two photos in each category. Include tear sheet or web printout and one print. A print of each photo is required for judging. No slides will be accepted.

CATEGORY 3) Outdoor Photography, Open - Photos on any outdoor-related subject. Members are allowed to enter two photos in each category. Include tear sheet or web printout and one print. A print of each photo is required for judging. No slides will be accepted.

CATEGORY 4) Outdoor Radio - Presentations and programs with an outdoor theme. Entries should be on cassette tape or CD and include no more than two programs. Date of broadcast will be certified on the entry form by station manager. Include two cassette tapes or CD copies of the program in a clasp envelope. Tape entry form to clasp less side of the envelope. Identify contest category on tape case in the event the tape becomes separated from entry envelope.

CATEGORY 5) Outdoor Television/Video - Presentations and programs with an outdoor theme. Entries can be instructional videos, commercial or non-commercial television programs, video news segments, for-profit productions, non-profit, agency, etc. Entering member's participation must be provided on entry form i.e., producer, narrator, camera operator, etc. Also, proof of distribution or airing must be certified on entry form by station manager for TV and producer for video. Include two VHS tapes or DVDs of the program in a clasp envelope. Tape entry form to clasp less side of the envelope. Identify contest category on tape case in the event the tape becomes separated from entry envelope.

CATEGORY 6) Outdoor Illustration/Graphic - Original artwork with an outdoor-related theme. Artwork must have been published and be the sole work of the member. Include tear sheet showing publication or printout of web page showing art. IF SENDING ORIGINAL ART, mount on stock of appropriate size. Attach entry form to back of mounting stock.

CATEGORY 7) Outdoor Publication (Newspaper or Magazine) Under 25,000 - Publications with an outdoor-related theme. TWO copies of the entire, original publication are to be included in entry packet. The TOWA member submitting the entry must be responsible for overall production of the publication - editor, publisher, owner, etc. Role of the TOWA member must be included on the entry form. Place materials in a manila envelope of appropriate size and tape entry form to clasp less side of envelope.

CATEGORY 8) Outdoor Publication (Newspaper or Magazine) Over 25,000 - Publications with an outdoor-related theme. TWO copies of the entire, original publication are to be included in entry packet. The TOWA member submitting the entry must be responsible for overall production of the publication - editor, publisher, owner, etc. Role of the TOWA member must be included on the entry form. Place materials in a manila envelope of

appropriate size and tape entry form to clasp less side of envelope.

CATEGORY 9) Outdoor Fiction/Humor - Fiction or Humor article with an outdoor-related theme. Can be from newspaper, magazine, Internet publication or newsletter. For individual articles/columns, submit only tear sheets. Do not send the entire publication. Entries should include two copies (one original tear sheet and one photocopy is acceptable). The copies should be submitted in one clasp-type manila envelope with the entry form affixed to the front of the envelope.

CATEGORY 10) Outdoor Column/Opinion Writing - Bylined column on an outdoor-related topic. Can be from newspaper, magazine, Internet publication or newsletter. For individual articles/columns, submit only tear sheets. Do not send the entire publication. Entries should include two copies (one original tear sheet and one photocopy is acceptable). The copies should be submitted in one clasp-type manila envelope with the entry form affixed to the front of the envelope.

CATEGORY 11) Newspaper Feature - Feature treatment of an outdoor-related topic in a newspaper of general circulation. Sidebars and graphics can be included. Submit one full-page tear sheet including byline, date and publication. Do not send the entire publication. Entries should include two copies (one original tear sheet and one photocopy is acceptable). The copies should be submitted in one clasp-type manila envelope with the entry form affixed to the front of the envelope.

CATEGORY 12) Magazine Feature - Feature treatment of an outdoor-related topic in a magazine of general circulation. Sidebars and graphics can be included. For individual articles/columns, submit only tear sheets. Do not send the entire publication. Entries should include two copies (one original tear sheet and one photocopy is acceptable). The copies should be submitted in one clasp-type manila envelope with the entry form affixed to the front of the envelope.

CATEGORY 13) Outdoor Feature, Open - Feature treatment of an outdoor-related topic in any publication of general circulation or other outdoor media venue. Sidebars and graphics can be included. For individual articles/columns, submit only tear sheets. Do not send the entire publication. Entries should include two copies (one original tear sheet and one photocopy is acceptable). The copies should be submitted in one clasp-type manila envelope with the entry form affixed to the front of the envelope. Radio and television/video entries must follow guidelines in Categories 4 and 5.

CATEGORY 14) Outdoor News Reporting - Reporting of an outdoor-related issue. This is a category for articles generally considered to be objective reporting of facts and issues

surrounding a topic or topics, and is to be judged by accepted standards of journalism. A series of articles on a single issue may be considered a single entry. Sidebars and graphics may be included. For individual articles/columns, submit only tear sheets. Do not send the entire publication. Entries should include two copies (one original tear sheet and one photocopy is acceptable). The copies should be submitted in one clasp-type manila envelope with the entry form affixed to the front of the envelope.

CATEGORY 15) Outdoor Book - Published book on an outdoor-related subject. Book can be fiction or non-fiction. Book must have been published during contest year. One copy of the book should be included in the entry packet, with entry forms attached to the books. Book will be returned at conference.

CATEGORY 16) Outdoor Web Page - Web site with an outdoor-related theme. Sites should be judged on their usefulness to the public and/or outdoor communicators. Entrants should include web address on entry form, and contest chairman will pass these addresses along to judges. The entry form should be affixed to the front of the envelope.

CATEGORY 17) Special Projects/Conservation - An article or broadcast that takes a conservation stand on a specific outdoor-related issue or educates and informs the public about conservation efforts. With videotape and radio entries, the entry must be the first and preferably only thing on the tape. A statement of the writer's/broadcaster's purpose or background on the issue is encouraged on the entry form, as this could assist judges in gauging impact of the work. For individual articles/columns, submit only tear sheets. Do not send the entire publication. Entries should include two copies (one original tear sheet and one photocopy is acceptable). For video entries, submit two video tapes or DVDs. For radio entries, submit two cassettes or CDs. The copies should be submitted in one clasp-type manila envelope with the entry form affixed to the front of the envelope.

CATEGORY 18) Original Internet Story/Blog – An article with an outdoor-related topic for which payment was received. Must be an original story and not a reprint. Entries should include two copies of the web page. The copies should be submitted in one clasp-type manila envelope with the entry form affixed to the front of the envelope.

TOWA Outstanding Outdoor Achievement Award (Trophy Only) – Recognition of outstanding contribution or performance of a supporting member in assisting TOWA in achieving its efforts to increase public awareness, understanding and appreciation of our outdoor heritage in the use and enjoyment of our natural resources. Nominees and a short letter of recommendation may be submitted to any member of the board.

TEXAS OUTDOOR WRITERS ASSOCIATION 2011 EXCELLENCE IN CRAFT ENTRY FORM

The Excellence In Craft Contest is an opportunity for active members to receive special recognition for journalism excellence. Submission must be outdoor oriented and must have been published, broadcast or distributed in Texas. Associate members are not eligible.

The TOWA Excellence in Craft Contest is proudly sponsored by Chevrolet.

CATEGORY NUMBER: _____

CATEGORY: _____

TITLE: _____

Your Name: _____

Address: _____

Name Of Publication and Circulation: _____

Date of Publication: _____

Your Role In Production (Video/TV Radio ONLY): _____

Distribution/Further Information: _____

Certified Signature: _____

Date: _____

COMMENTS: (Purpose statement, technical data, etc. that might assist the judges in evaluating your entry)

Each entry in any category will require an entry fee of \$10. You may write one check for the total amount of all categories entered. All entries must be postmarked no later than Dec.1, 2010. Any entry received after this date will be returned unopened.

Send package and check (made out to TOWA) to: Kendal Hemphill
TOWA EIC Chairman
P.O. Box 1600
Mason, TX 76856

Lower Pecos Canyon Area Rock Art Images Sought for Research Project

TOWA Life Member Bob Hood is passing along the following request for any of our members who have visited the Lower Pecos Canyon area and may have images that will assist with this project.

The members of Studying the Human Use of Materials, Land and Art, and their partners with the Amistad National Recreation Area, Seminole Canyon State Park and Historic Site, and The Bank & Trust of Del Rio have undertaken a research project aimed at recording the world-class rock art site at Panther Cave.

This site is one of more than 250 rock art panels and sites that are scattered through the Lower Pecos Canyon area. Many of these sites are threatened by vandalism, scouring by livestock, windborne soil erosion, flooding, insect damage (discussed in the mud dauber article above) and possible effects of humidity on the rock art panels.

In the Panther Cave Photo Legacy Project, SHUMLA is

searching for any photographs taken of the rock art at this site before the year 2000. Color slides, color or black and white prints, or digital images will provide a photographic record of the site that will allow archeologists to identify trends in deterioration and gauge rates of change, in particular following the impoundment of Amistad Reservoir.

"Before the day of digital cameras, visitors to the Lower Pecos rock art sites took thousands of photographs on film. To date, we've found nearly 600 great photos in private collections in Midland, Kerrville, San Antonio, Austin, Del Rio, Comstock, Brackettville, Albuquerque, and Cranston, Rhode Island, and 5,000 more in San Antonio, Austin and Las Cruces," said Bill Sontag, project coordinator.

"Even though we're looking for older photos, we've learned that relatively recent photos can be of great use, as well. For example, Bob Parvin's 1980s pictures of Panther Cave showed us no mud daubers in one patch of the famed panel, whereas later photos showed many."

Whether you have slides, prints or digitals, safe transport will be arranged to SHUMLA. If high-resolution (600dpi or greater) digital images or scans cannot be emailed, Sontag will pick up the photos, and personally take them to Angel Johnson, SHUMLA research assistant. The images are then scanned into the SHUMLA database. Sontag will then return the photos to their owners when it is convenient for all concerned.

In the future, the collected images may be published in academic reports, brochures, books or scientific monographs, but any and all photos used or provided by SHUMLA will be dated and credited to the photographer or contributor. We may also use your photos in audiovisual presentations to help establish baseline conditions of the art and demonstrate how it has changed over the years, all aimed at bettering resource management in perpetuity.

Please contact Sontag to discuss any photos you might have to share with this important documentation and preservation project. He can be reached at: billsontag@stx.rr.com; by phone at (830) 768-1393 or (830) 719-2756.



Rock art such as this from Seminole Canyon State Park is degrading — and sometimes disappearing — from natural elements such as humidity, flooding, insect damage and soil erosion, as well as from acts of vandalism. Images of the rock art prior to the year 2000 are being sought to assemble a record of the world-class rock art site.

TOWA Member Mike Cox Honored with A.C. Greene Award

Austin author, journalist and historian Mike Cox was the recipient of the A.C. Greene Literary Award during ceremonies Sept. 25 at the 10th annual West Texas Book & Music Festival in Abilene.

Cox was honored for his body of work, some 17 books to date, including an acclaimed two-volume history of the Texas Rangers and several collections of historic Texas photos. As part of the festival, Cox presented a program on the Texas Oil Patch with Panhandle historian and author Bobby Weaver.

The A.C. Greene Award is presented annually to a distinguished Texas author for lifetime achievement. The award is named for author, columnist and Abilene native, A.C. Greene. Past winners of the Green Award include John Graves, Elmer Kelton, Walt McDonald, Sandra Brown, Jane Roberts Wood, Liz Carpenter and Don Graham.

Cox has also penned a study of Texas disasters, three other books on the Texas Rangers, one collection of historical stories, one true crime story, a biography, a memoir and two local histories, as well as numerous magazine articles, essays and introductions for other books. He has been an elected member of the Texas Institute of Letters since 1993.

Since 2000, Cox has written a syndicated weekly newspaper column called "Texas Tales" on interesting, little-known incidents in Texas history. In 1982 he began writing "Texana," a Texas book review column for the Austin American-Statesman.

His byline regularly appears in a number of national and statewide magazines, including Texas Highways, Texas Parks and Wildlife Magazine and Texas Sportsman. In addition, he has written articles and monographs for a wide variety of Texas historical associations, museums and non-profit organizations.

Cox retired in the fall of 2007 as communication manager for the Texas Department of Transportation. Prior to that, he spent more than 15 years with the Texas Department of Public Safety as chief of media relations and public information officer. In between, he was director of Member Services for the Texas Press Association. He was an award-winning newspaper reporter for nearly 20 years, most of that time with the Austin American-Statesman.

He lives in Austin, Texas with his wife Linda and daughter Hallie.

The festival, which began as the West Texas Book & Author Festival in 2001, is presented by Friends of the Abilene Public Library and the Abilene Reporter-News.

Funds raised by the festival support a variety of library activities, including the Texas Author Series, which brings in noted Texas authors for brown bag programs throughout the year.

More information about the festival, the Friends of the Library, and the Abilene Public Library is available on the library's web site, www.abilenetx.com/apl.

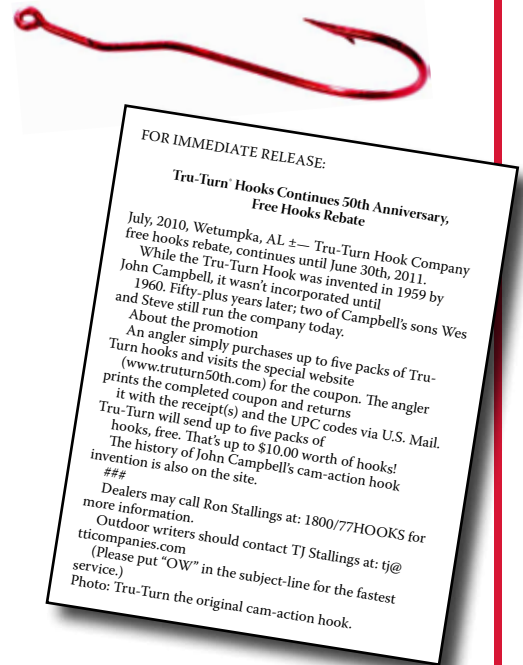

Press releases and accompanying photos can be easily accessed at the TTI-Blakemore Fishing Group's Online Press Center.

TTI-Blakemore Press Kit to be Provided Online

TJ Stallings, veteran TOWA supporting member and head of marketing and crazy ideas for the TTI-Blakemore Fishing Group, has sent out an alert to TOWA members that he is doing his part to save a tree.

The 2011 TTI-Blakemore press kit is being made available online by following the link: http://ttiblakemore.com/shop/index.php?main_page=index&cPath=122. The user name is "outdoorwriter" (all one word) and the password is 2011.

Members who are still struggling with modern technology and space age doodads may contact Stallings at (334) 567-2011 or by email at tj@tticompanies.com if they would prefer to receive an e-mailed copy or have a printed copy mailed to their address.

Stallings added that most new product samples will be available in early October.